







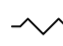

NOTES

1. THIS DRAWING IS TO BE READ IN CONJUNCTION WITH ALL OTHER RELEVANT DOCUMENTATION.
2. DO NOT SCALE FROM THIS DRAWING, USE ONLY PRINTED DIMENSIONS.
3. ALL DIMENSIONS IN MILLIMETRES, ALL CHAINAGES, LEVELS AND COORDINATES ARE IN METRES UNLESS DEFINED OTHERWISE.
4. THIS DRAWING IS TO BE READ IN CONJUNCTION WITH THE PROJECT HEALTH & SAFETY FILE FOR ANY IDENTIFIED POTENTIAL RISKS.
5. THIS PLAN WAS AMENDED IN MAY 2020 TO REMOVE A SMALL AREA OF THE ORDER LIMITS WITHIN THE HIGHWAY BOUNDARY OF THE M54 PREVIOUSLY INCLUDED FOR THE REPLACEMENT OF A ROAD SIGN. THE REPLACEMENT OF THIS SIGN IS NO LONGER REQUIRED. THIS CHANGE MEANS THAT SHROPSHIRE COUNTY COUNCIL IS NO LONGER A HOST AUTHORITY FOR THE SCHEME.

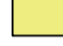
KEY

-  LIMITS OF LAND TO BE ACQUIRED OR USED PERMANENTLY OR TEMPORARILY (THE ORDER LIMITS)
-  LAND NOT INCLUDED WITHIN THE ORDER LIMITS
-  RETAINING WALLS
-  NON-MOTORISED USER ROUTE (PLEASE REFER TO STREETS, RIGHTS OF WAY AND ACCESS PLANS [TR010054/APP/2.7] FOR MORE INFORMATION)
-  EMBANKMENTS
-  CUTTINGS
-  VERGES / GRASSED AREAS

First Issue in Draft	MW	AM	21/12/18	P01
No significant changes noted from previous revision	JD	AM	22/02/19	P02
No significant changes noted from previous revision	MW	AM	29/03/19	P03
No significant changes noted from previous revision	JP	AM	14/05/19	P04
No significant changes noted from previous revision	MW	DYT	15/08/19	P05
Refer to Design Change Tracker for details	JP	RR	30/10/19	P06
Background colour added	JP	DL	17/12/19	P07
Minor amendments.	MW	RR	21/01/20	P08
Sheet 1 Inset 'A' removed.	MW	RR	12/03/20	P09
Note 5 added.	MW	RR	11/05/20	P10
Hatching and key updated.	MW	RR	08/10/20	P11
Revision Details	By	Check	Date	Suffix

Purpose of issue  
**DCO APPLICATION**

Client  
Highways England  
Floor 5  
Two Colmore Square  
38 Colmore Circus  
Birmingham  
B4 6BN



Development Consent Order Number  
**TR010054**

Project Title  
**M54 to M6 Link Road**

Development Consent Order Drawing Number  
**TR010054/APP/2.5**

Drawing Title  
**GENERAL ARRANGEMENT  
REGULATION 5(2)(O)  
SHEET 1 OF 10**

Designed	Drawn	Checked	Approved	Date
---	MW	AM	RR	08/10/20

Internal Project No.  
60536736

Scale @ A1  
1:2500H/1:2500V

Suitability  
S8

Zone  
Highways General

THIS DOCUMENT HAS BEEN PREPARED PURSUANT TO AND SUBJECT TO THE TERMS OF AECOM'S APPOINTMENT BY ITS CLIENT. AECOM ACCEPTS NO LIABILITY FOR ANY USE OF THIS DOCUMENT OTHER THAN BY ITS ORIGINAL CLIENT OR FOLLOWING AECOM'S EXPRESS AGREEMENT TO SUCH USE, AND ONLY FOR THE PURPOSES FOR WHICH IT WAS PREPARED AND PROVIDED.

Drawing Number	Highways England PIN	I Originator	I Volume	Rev
HE514465	-ACM	-HGN-		P11
Z1_SW_PR_Z		-DR-CH-1001		
Location	I Type	I Role	I Number	

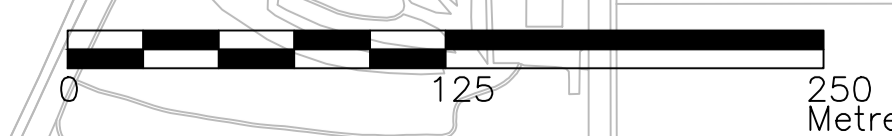

This map is reproduced from Ordnance Survey material with the permission of Ordnance Survey on behalf of the Controller of Her Majesty's Stationary Office © Crown copyright. Unauthorised reproduction infringes Crown copyright and may lead to prosecution or civil proceedings. Highways England 100030649(2020)

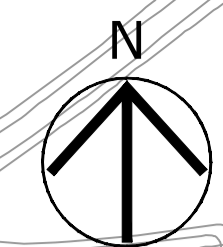
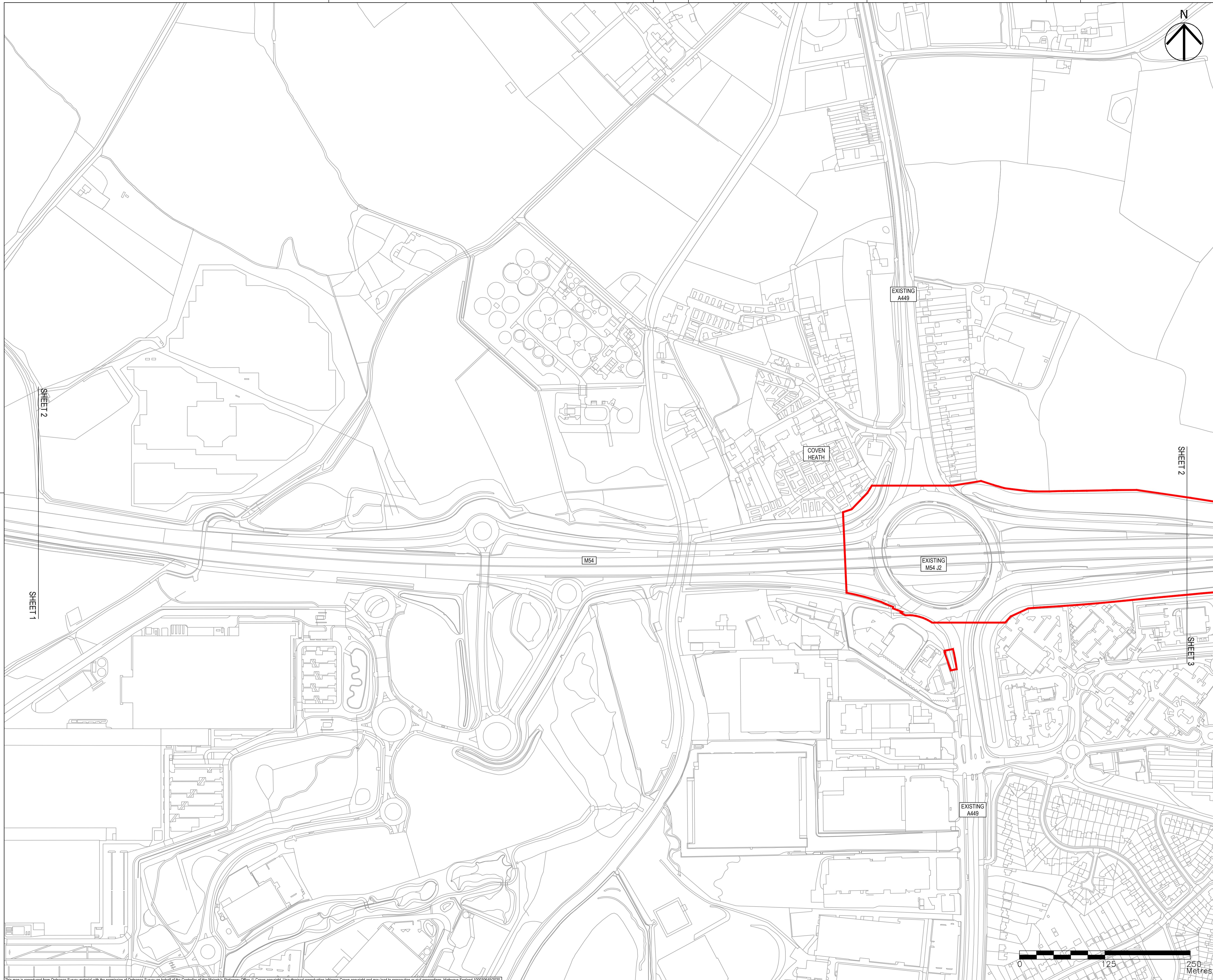

- NOTES**
- THIS DRAWING IS TO BE READ IN CONJUNCTION WITH ALL OTHER RELEVANT DOCUMENTATION.
  - DO NOT SCALE FROM THIS DRAWING. USE ONLY PRINTED DIMENSIONS.
  - ALL DIMENSIONS IN MILLIMETRES. ALL CHAINAGES, LEVELS AND COORDINATES ARE IN METRES UNLESS DEFINED OTHERWISE.
  - THIS DRAWING IS TO BE READ IN CONJUNCTION WITH THE PROJECT HEALTH & SAFETY FILE FOR ANY IDENTIFIED POTENTIAL RISKS.

- KEY**
- LIMITS OF LAND TO BE ACQUIRED OR USED PERMANENTLY OR TEMPORARILY (THE ORDER LIMITS)
  - LAND NOT INCLUDED WITHIN THE ORDER LIMITS
  - RETAINING WALLS
  - NON-MOTORISED USER ROUTE (PLEASE REFER TO STREETS, RIGHTS OF WAY AND ACCESS PLANS [TR010054/APP/2.7] FOR MORE INFORMATION)
  - EMBANKMENTS
  - CUTTINGS
  - VERGES / GRASSED AREAS

First Issue in Draft	MW	AM	21/12/18	P01
See Revision Notes for further details.	JD	AM	22/02/19	P02
No significant changes noted from previous revision	MW	AM	29/03/19	P03
No significant changes noted from previous revision	JP	AM	14/05/19	P04
Refer to Design Change Tracker for details	HS	DYT	15/08/19	P05
Refer to Design Change Tracker for details	JP	RR	30/10/19	P06
Background colour added	JP	DL	17/12/19	P07
Minor amendments.	MW	RR	21/01/20	P08
Hatching and key updated.	MW	RR	08/10/20	P09
Revision Details	By	Check	Date	Suffix

**DCO APPLICATION**

Client  
Highways England  
Floor 5  
Two Colmore Square  
38 Colmore Circus  
Birmingham  
B4 6BN

Development Consent Order Number  
**TR010054**

Project Title  
**M54 to M6 Link Road**

Development Consent Order Drawing Number  
**TR010054/APP/2.5**

Drawing Title  
**GENERAL ARRANGEMENT  
REGULATION 5(2)(O)  
SHEET 2 OF 10**

Designed	Drawn	Checked	Approved	Date
---	MW	AM	RR	08/10/20
Internal Project No.	Suitability			
60536736	S8			
Scale @ A1	Zone			
1:2500H/1:2500V	Highways General			

THIS DOCUMENT HAS BEEN PREPARED PURSUANT TO AND SUBJECT TO THE TERMS OF AECOM'S APPOINTMENT BY ITS CLIENT. AECOM ACCEPTS NO LIABILITY FOR ANY USE OF THIS DOCUMENT OTHER THAN BY ITS ORIGINAL CLIENT OR FOLLOWING AECOM'S EXPRESS AGREEMENT TO SUCH USE, AND ONLY FOR THE PURPOSES FOR WHICH IT WAS PREPARED AND PROVIDED.

Drawing Number	1 Originator	1 Volume	Rev
HE514465 -ACM	-HGN-		P09
Z1_SW_PR_Z	-DR-CH-1002		
Location	1 Type	1 Role	1 Number



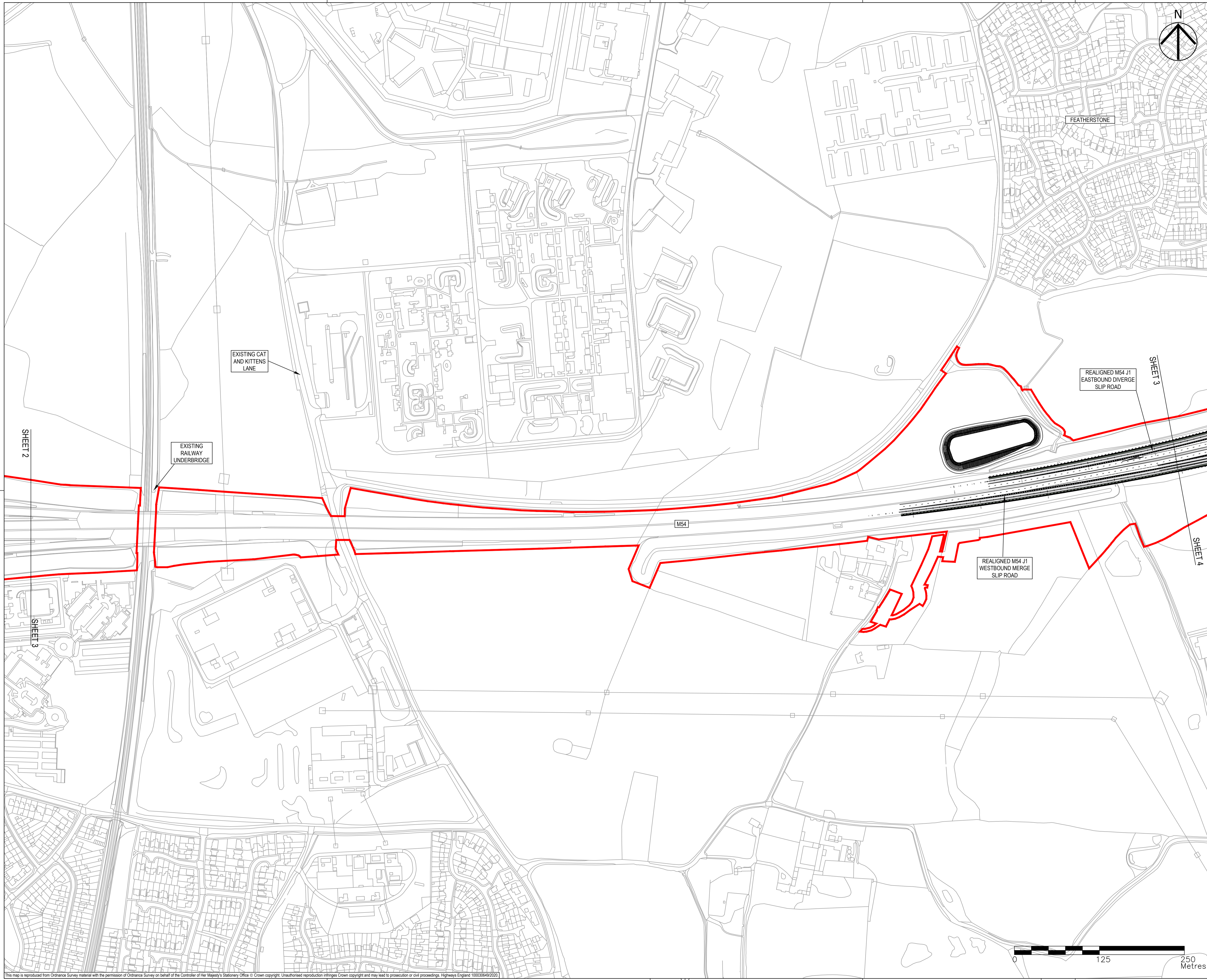

- NOTES**
- THIS DRAWING IS TO BE READ IN CONJUNCTION WITH ALL OTHER RELEVANT DOCUMENTATION.
  - DO NOT SCALE FROM THIS DRAWING. USE ONLY PRINTED DIMENSIONS.
  - ALL DIMENSIONS IN MILLIMETRES. ALL CHAINAGES, LEVELS AND COORDINATES ARE IN METRES UNLESS DEFINED OTHERWISE.
  - THIS DRAWING IS TO BE READ IN CONJUNCTION WITH THE PROJECT HEALTH & SAFETY FILE FOR ANY IDENTIFIED POTENTIAL RISKS.

- KEY**
- LIMITS OF LAND TO BE ACQUIRED OR USED PERMANENTLY OR TEMPORARILY (THE ORDER LIMITS)
  - LAND NOT INCLUDED WITHIN THE ORDER LIMITS
  - RETAINING WALLS
  - NON-MOTORISED USER ROUTE (PLEASE REFER TO STREETS, RIGHTS OF WAY AND ACCESS PLANS [TR010054/APP/2.7] FOR MORE INFORMATION)
  - EMBANKMENTS
  - CUTTINGS
  - VERGES / GRASSED AREAS

Revision Details	By	Check	Date	Suffix
First Issue in Draft	MW	AM	21/12/18	P01
See Revision Notes for further details.	JD	AM	22/02/19	P02
See Revision Notes for further details.	MW	AM	29/03/19	P03
A460 Turning Head Added. Road Markings and Hatching Added.	AM	AM	10/05/19	P04
Refer to Design Change Tracker for details	HS	DYT	15/08/19	P05
Refer to Design Change Tracker for details	JP	RR	30/10/19	P06
Background colour added	JP	DL	17/12/19	P07
Minor amendments.	MW	RR	21/01/20	P08
Updated to reflect Oct 2020 scheme changes.	MW	AM	18/09/20	P09
Hatching and key updated.	MW	RR	08/10/20	P10

**DCO APPLICATION**

Client  
 Highways England  
 Floor 5  
 Two Colmore Square  
 38 Colmore Circus  
 Birmingham  
 B4 6BN

Development Consent Order Number  
**TR010054**

Project Title  
**M54 to M6 Link Road**

Development Consent Order Drawing Number  
**TR010054/APP/2.5**

Drawing Title  
**GENERAL ARRANGEMENT  
 REGULATION 5(2)(O)  
 SHEET 3 OF 10**

Designed	Drawn	Checked	Approved	Date
---	MW	AM	RR	08/10/20

Internal Project No. 60536736  
 Suitability S8  
 Scale @ A1 1:2500H/1:2500V  
 Zone Highways General

THIS DOCUMENT HAS BEEN PREPARED PURSUANT TO AND SUBJECT TO THE TERMS OF AECOM'S APPOINTMENT BY ITS CLIENT. AECOM ACCEPTS NO LIABILITY FOR ANY USE OF THIS DOCUMENT OTHER THAN BY ITS ORIGINAL CLIENT OR FOLLOWING AECOM'S EXPRESS AGREEMENT TO SUCH USE, AND ONLY FOR THE PURPOSES FOR WHICH IT WAS PREPARED AND PROVIDED.

Drawing Number	Highways England PIN	I Originator	I Volume	Rev
HE514465	-ACM	-HGN-		P10
Z1_SW_PR_Z		-DR-CH-1003		

Location I Type I Role I Number

This map is reproduced from Ordnance Survey material with the permission of Ordnance Survey on behalf of the Controller of Her Majesty's Stationery Office © Crown copyright. Unauthorised reproduction infringes Crown copyright and may lead to prosecution or civil proceedings. Highways England 100030549(2020)

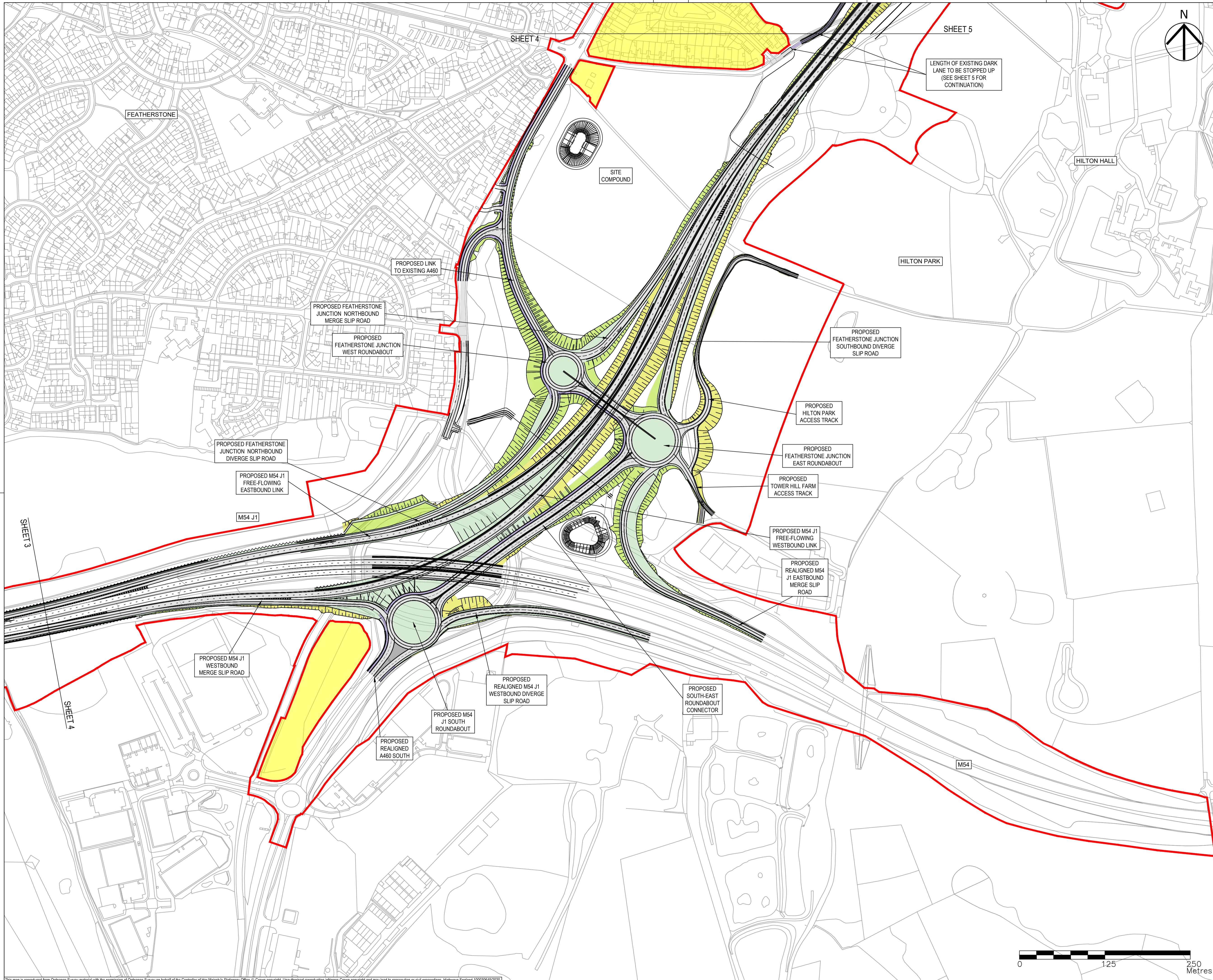

- NOTES
- THIS DRAWING IS TO BE READ IN CONJUNCTION WITH ALL OTHER RELEVANT DOCUMENTATION.
  - DO NOT SCALE FROM THIS DRAWING. USE ONLY PRINTED DIMENSIONS.
  - ALL DIMENSIONS IN MILLIMETRES. ALL CHAINAGES, LEVELS AND COORDINATES ARE IN METRES UNLESS DEFINED OTHERWISE.
  - THIS DRAWING IS TO BE READ IN CONJUNCTION WITH THE PROJECT HEALTH & SAFETY FILE FOR ANY IDENTIFIED POTENTIAL RISKS.

- KEY
- LIMITS OF LAND TO BE ACQUIRED OR USED PERMANENTLY OR TEMPORARILY (THE ORDER LIMITS)
  - LAND NOT INCLUDED WITHIN THE ORDER LIMITS
  - RETAINING WALLS
  - NON-MOTORISED USER ROUTE (PLEASE REFER TO STREETS, RIGHTS OF WAY AND ACCESS PLANS [TR010054/APP/2.7] FOR MORE INFORMATION)
  - EMBANKMENTS
  - CUTTINGS
  - VERGES / GRASSED AREAS

Revision Details	By	Date	Suffix
First Issue in Draft	MW	21/12/18	P01
See Revision Notes for further details	JD	22/02/19	P02
No significant changes noted from previous revision	MW	29/03/19	P03
No significant changes noted from previous revision	JP	14/05/19	P04
No significant changes noted from previous revision	HS	15/08/19	P05
Refer to Design Change Tracker for details	JP	30/10/19	P06
Background colour added	JP	17/12/19	P07
Minor amendments	MW	21/01/20	P08
Updated to reflect Oct 2020 scheme changes	MW	18/09/20	P09
Hatching and key updated	MW	08/10/20	P10

Purpose of Issue  
**DCO APPLICATION**

Client  
Highways England  
Floor 5  
Two Colmore Square  
38 Colmore Circus  
Birmingham  
B4 6BN

Development Consent Order Number  
**TR010054**

Project Title  
**M54 to M6 Link Road**

Development Consent Order Drawing Number  
**TR010054/APP/2.5**

Drawing Title  
**GENERAL ARRANGEMENT  
REGULATION 5(2)(O)  
SHEET 4 OF 10**

Designed	Drawn	Checked	Approved	Date
---	MW	AM	RR	08/10/20
Internal Project No. 60536736	Suitability S8			
Scale @ A1 1:2500H/1:2500V	Zone Highways General			
THIS DOCUMENT HAS BEEN PREPARED PURSUANT TO AND SUBJECT TO THE TERMS OF AECOM'S APPOINTMENT BY ITS CLIENT. AECOM ACCEPTS NO LIABILITY FOR ANY USE OF THIS DOCUMENT OTHER THAN BY ITS ORIGINAL CLIENT OR FOLLOWING AECOM'S EXPRESS AGREEMENT TO SUCH USE, AND ONLY FOR THE PURPOSES FOR WHICH IT WAS PREPARED AND PROVIDED.				
Drawing Number HE514465	Drawn -ACM	Checked -HGN-	Approved -DR-CH-1004	Rev P10
Location Z1_SW_PR_Z				Type   Role   Number

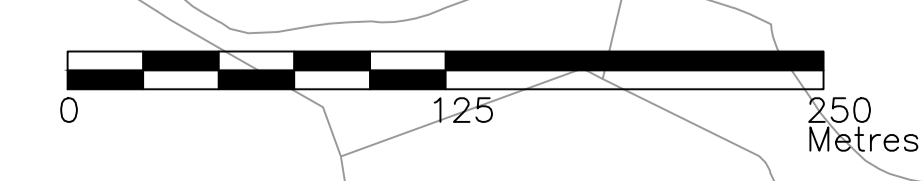

This map is reproduced from Ordnance Survey material with the permission of Ordnance Survey on behalf of the Controller of Her Majesty's Stationery Office © Crown copyright. Unauthorised reproduction infringes Crown copyright and may lead to prosecution or civil proceedings. Highways England 100030649(2020)

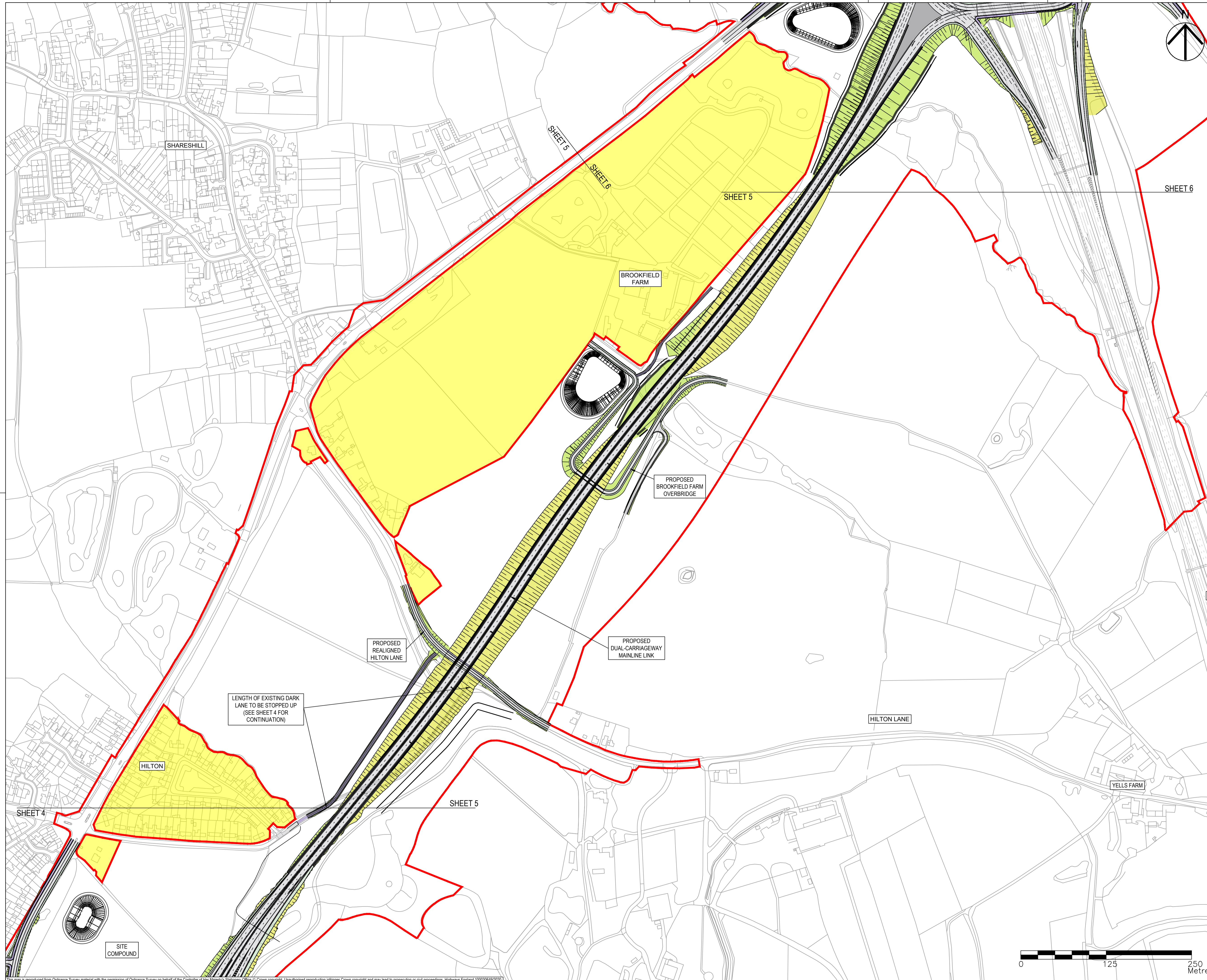

- NOTES**
1. THIS DRAWING IS TO BE READ IN CONJUNCTION WITH ALL OTHER RELEVANT DOCUMENTATION.
  2. DO NOT SCALE FROM THIS DRAWING, USE ONLY PRINTED DIMENSIONS.
  3. ALL DIMENSIONS IN MILLIMETRES, ALL CHAINAGES, LEVELS AND COORDINATES ARE IN METRES UNLESS DEFINED OTHERWISE.
  4. THIS DRAWING IS TO BE READ IN CONJUNCTION WITH THE PROJECT HEALTH & SAFETY FILE FOR ANY IDENTIFIED POTENTIAL RISKS.

- KEY**
- LIMITS OF LAND TO BE ACQUIRED OR USED PERMANENTLY OR TEMPORARILY (THE ORDER LIMITS)
  - LAND NOT INCLUDED WITHIN THE ORDER LIMITS
  - RETAINING WALLS
  - NON-MOTORISED USER ROUTE (PLEASE REFER TO STREETS, RIGHTS OF WAY AND ACCESS PLANS [TR010054/APP/2.7] FOR MORE INFORMATION)
  - EMBANKMENTS
  - CUTTINGS
  - VERGES / GRASSED AREAS

Revision Details	By	Check	Date	Suffix
First Issue in Draft	MW	AM	21/12/18	P01
No significant changes noted from previous revision	JD	AM	22/02/19	P02
See Revision Notes for further details.	MW	AM	29/03/19	P03
Tower Farm Acc Bridge Removed	AM	AM	10/05/19	P04
Refer to Design Change Tracker for details	HS	DYT	15/08/19	P05
Refer to Design Change Tracker for details	JP	RR	30/10/19	P06
Background colour added	JP	DL	17/12/19	P07
Minor amendments.	MW	RR	21/01/20	P08
Updated to reflect Oct 2020 scheme changes.	MW	AM	18/09/20	P09
Hatching and key updated.	MW	RR	08/10/20	P10

**DCO APPLICATION**

Client  
 Highways England  
 Floor 5  
 Two Colmore Square  
 38 Colmore Circus  
 Birmingham  
 B4 6BN

Development Consent Order Number  
**TR010054**

Project Title  
**M54 to M6 Link Road**

Development Consent Order Drawing Number  
**TR010054/APP/2.5**

Drawing Title  
**GENERAL ARRANGEMENT  
 REGULATION 5(2)(O)  
 SHEET 5 OF 10**

Designed	Drawn	Checked	Approved	Date
---	MW	AM	RR	08/10/20

Internal Project No. 60536736  
 Scale @ A1 1:2500H/1:2500V  
 Suitability S8  
 Zone Highways General

THIS DOCUMENT HAS BEEN PREPARED PURSUANT TO AND SUBJECT TO THE TERMS OF AECOM'S APPOINTMENT BY ITS CLIENT. AECOM ACCEPTS NO LIABILITY FOR ANY USE OF THIS DOCUMENT OTHER THAN BY ITS ORIGINAL CLIENT OR FOLLOWING AECOM'S EXPRESS AGREEMENT TO SUCH USE, AND ONLY FOR THE PURPOSES FOR WHICH IT WAS PREPARED AND PROVIDED.

Drawing Number	Originator	Volume	Rev
HE514465 -ACM	HGN-	1	P10
Z2_SW_PR_Z	-DR-CH-1005	1	1

This map is reproduced from Ordnance Survey material with the permission of Ordnance Survey on behalf of the Controller of Her Majesty's Stationery Office © Crown copyright. Unauthorised reproduction infringes Crown copyright and may lead to prosecution or civil proceedings. Highways England 100030649(2020)

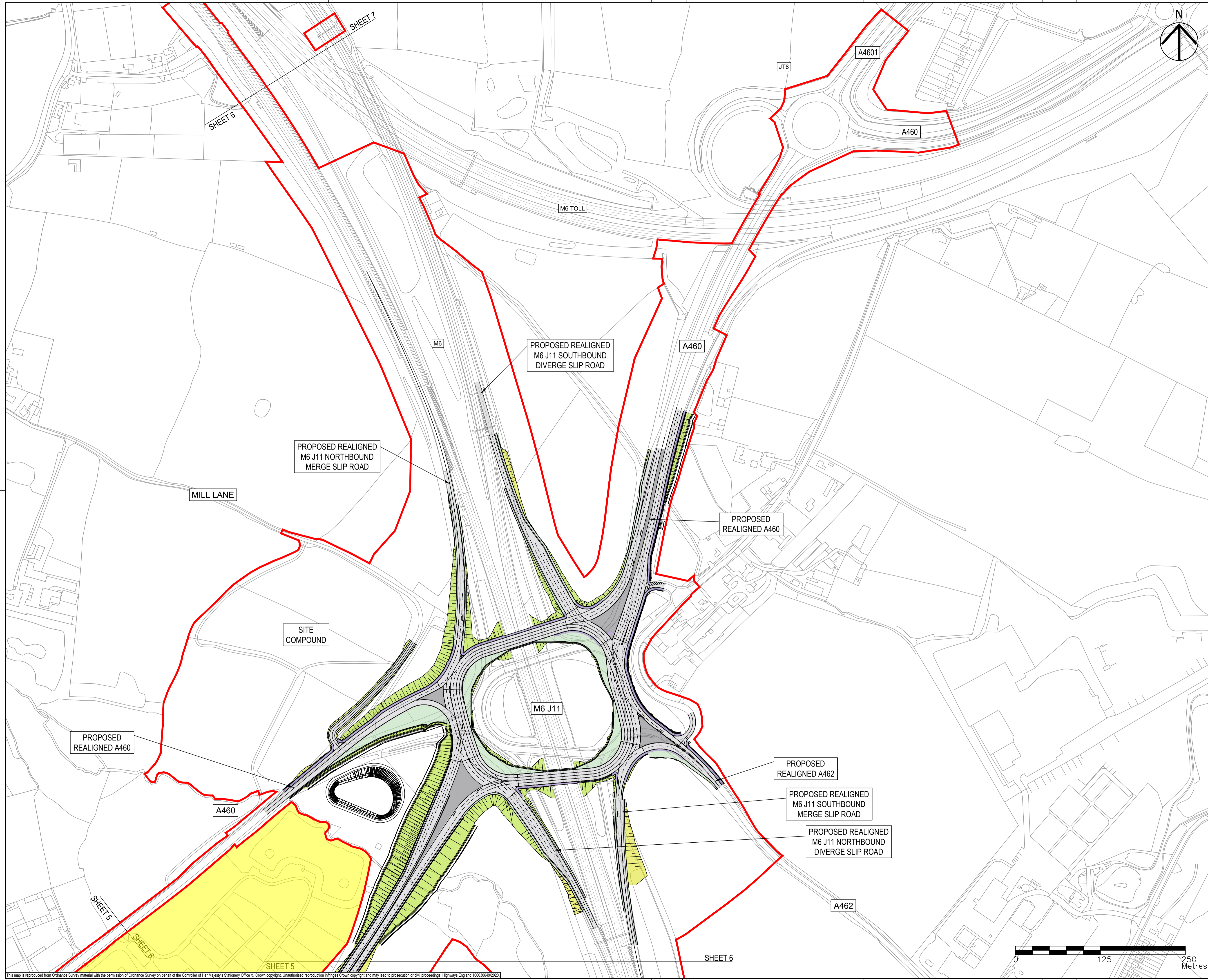

- NOTES
1. THIS DRAWING IS TO BE READ IN CONJUNCTION WITH ALL OTHER RELEVANT DOCUMENTATION.
  2. DO NOT SCALE FROM THIS DRAWING. USE ONLY PRINTED DIMENSIONS.
  3. ALL DIMENSIONS IN MILLIMETRES. ALL CHAINAGES, LEVELS AND COORDINATES ARE IN METRES UNLESS DEFINED OTHERWISE.
  4. THIS DRAWING IS TO BE READ IN CONJUNCTION WITH THE PROJECT HEALTH & SAFETY FILE FOR ANY IDENTIFIED POTENTIAL RISKS.

- KEY
- LIMITS OF LAND TO BE ACQUIRED OR USED PERMANENTLY OR TEMPORARILY (THE ORDER LIMITS)
  - LAND NOT INCLUDED WITHIN THE ORDER LIMITS
  - RETAINING WALLS
  - NON-MOTORISED USER ROUTE (PLEASE REFER TO STREETS, RIGHTS OF WAY AND ACCESS PLANS [TR010054/APP/2.7] FOR MORE INFORMATION)
  - EMBANKMENTS
  - CUTTINGS
  - VERGES / GRASSED AREAS

Revision Details	By	Date	Suffix
First Issue in Draft	MW	21/12/18	P01
See Revision Notes for further details	JD	22/02/19	P02
See Revision Notes for further details	MW	29/03/19	P03
See Revision Notes for further details	JP	14/05/19	P04
Refer to Design Change Tracker for details	HS	15/08/19	P05
Refer to Design Change Tracker for details	JP	30/10/19	P06
Background colour added	JP	17/12/19	P07
Minor amendments.	MW	21/01/20	P08
Updated to reflect Oct 2020 scheme changes.	MW	18/09/20	P09
Hatching and key updated.	MW	08/10/20	P10

Purpose of Issue  
**DCO APPLICATION**

Client  
Highways England  
Floor 5  
Two Colmore Square  
38 Colmore Circus  
Birmingham  
B4 6BN

Development Consent Order Number  
**TR010054**

Project Title  
**M54 to M6 Link Road**

Development Consent Order Drawing Number  
**TR010054/APP/2.5**

Drawing Title  
**GENERAL ARRANGEMENT REGULATION 5(2)(O) SHEET 6 OF 10**

Designed	Drawn	Checked	Approved	Date
---	MW	AM	RR	08/10/20

Internal Project No. 60536736  
Scale @ A1 1:2500H/1:2500V  
Suitability S8  
Zone Highways General

THIS DOCUMENT HAS BEEN PREPARED PURSUANT TO AND SUBJECT TO THE TERMS OF AECOM'S APPOINTMENT BY ITS CLIENT. AECOM ACCEPTS NO LIABILITY FOR ANY USE OF THIS DOCUMENT OTHER THAN BY ITS ORIGINAL CLIENT OR FOLLOWING AECOM'S EXPRESS AGREEMENT TO SUCH USE, AND ONLY FOR THE PURPOSES FOR WHICH IT WAS PREPARED AND PROVIDED.

Drawing Number	Highways England PIN	1 Originator	1 Volume	Rev
HE514465	-ACM	-HGN-		P10
Z3 SW_PR_Z		-DR-CH-1006		

Location: I Type I Role I Number

This map is reproduced from Ordnance Survey material with the permission of Ordnance Survey on behalf of the Controller of Her Majesty's Stationary Office © Crown copyright. Unauthorised reproduction infringes Crown copyright and may lead to prosecution or civil proceedings. Highways England 100030549(2020)

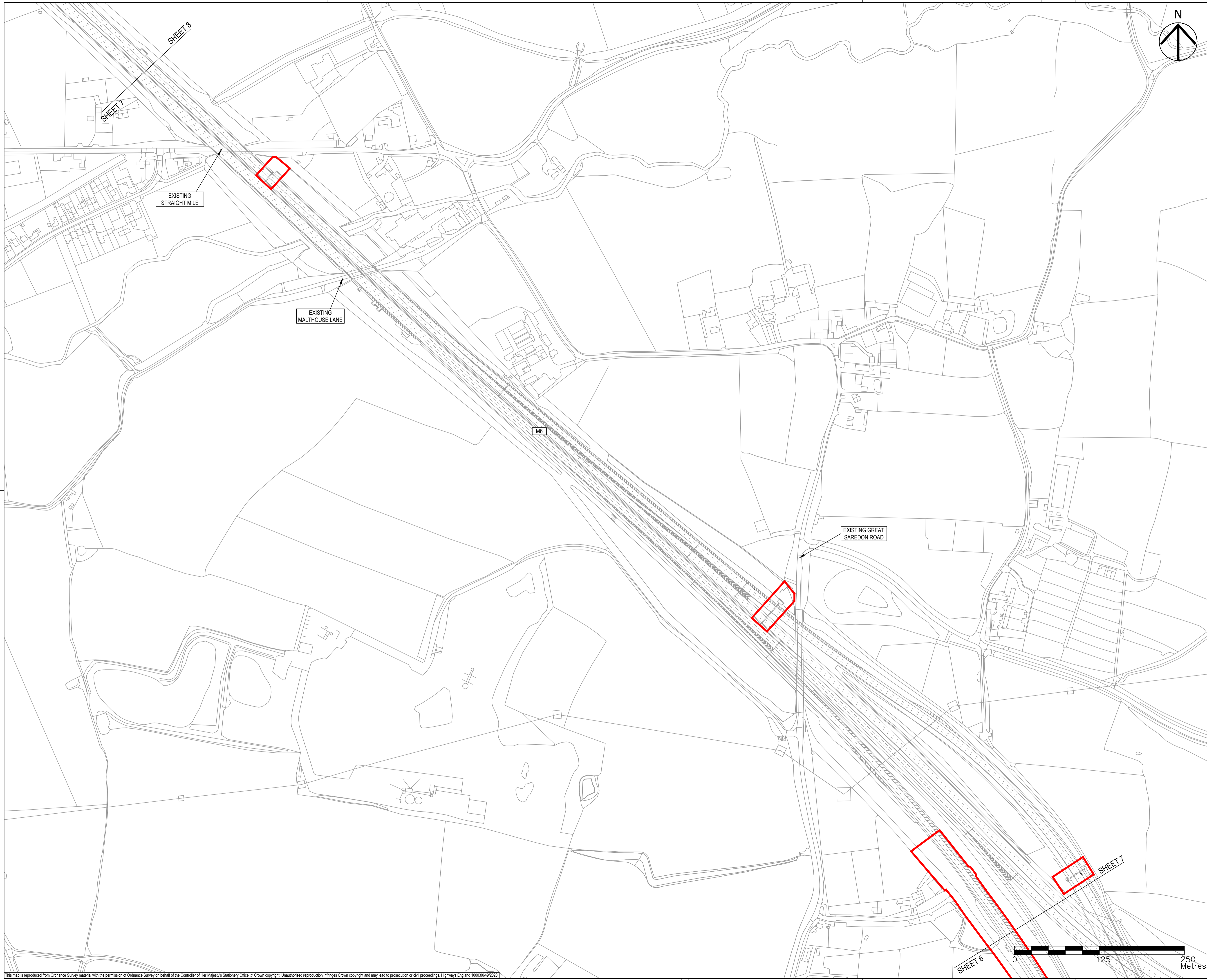

- NOTES
- THIS DRAWING IS TO BE READ IN CONJUNCTION WITH ALL OTHER RELEVANT DOCUMENTATION.
  - DO NOT SCALE FROM THIS DRAWING, USE ONLY PRINTED DIMENSIONS.
  - ALL DIMENSIONS IN MILLIMETRES, ALL CHAINAGES, LEVELS AND COORDINATES ARE IN METRES UNLESS DEFINED OTHERWISE.
  - THIS DRAWING IS TO BE READ IN CONJUNCTION WITH THE PROJECT HEALTH & SAFETY FILE FOR ANY IDENTIFIED POTENTIAL RISKS.

- KEY
- LIMITS OF LAND TO BE ACQUIRED OR USED PERMANENTLY OR TEMPORARILY (THE ORDER LIMITS)
  - LAND NOT INCLUDED WITHIN THE ORDER LIMITS
  - RETAINING WALLS
  - NON-MOTORISED USER ROUTE (PLEASE REFER TO STREETS, RIGHTS OF WAY AND ACCESS PLANS [TR010054/APP/2.7] FOR MORE INFORMATION)
  - EMBANKMENTS
  - CUTTINGS
  - VERGES / GRASSED AREAS

Revision Details	By	Date	Suffix
First Issue in Draft	MW	21/12/18	P01
See Revision Notes for further details	JD	22/02/19	P02
See Revision Notes for further details	MW	29/03/19	P03
Road Markings and Hatching Added.	AM	10/05/19	P04
Refer to Design Change Tracker for details	HS	15/08/19	P05
Refer to Design Change Tracker for details	JP	30/10/19	P06
Background colour added	JP	17/12/19	P07
Minor amendments.	MW	21/01/20	P08
Hatching and key updated.	MW	08/10/20	P09

Purpose of issue  
**DCO APPLICATION**

Client  
Highways England  
Floor 5  
Two Colmore Square  
38 Colmore Circus  
Birmingham  
B4 6BN

Development Consent Order Number  
**TR010054**

Project Title  
**M54 to M6 Link Road**

Development Consent Order Drawing Number  
**TR010054/APP/2.5**

Drawing Title  
**GENERAL ARRANGEMENT  
REGULATION 5(2)(O)  
SHEET 7 OF 10**

Designed	Drawn	Checked	Approved	Date
MW	MW	AM	RR	08/10/20

Internal Project No. 60536736  
Scale @ A1 1:2500H/1:2500V  
Suitability S8  
Zone Highways General

THIS DOCUMENT HAS BEEN PREPARED PURSUANT TO AND SUBJECT TO THE TERMS OF AECOM'S APPOINTMENT BY ITS CLIENT. AECOM ACCEPTS NO LIABILITY FOR ANY USE OF THIS DOCUMENT OTHER THAN BY ITS ORIGINAL CLIENT OR FOLLOWING AECOM'S EXPRESS AGREEMENT TO SUCH USE, AND ONLY FOR THE PURPOSES FOR WHICH IT WAS PREPARED AND PROVIDED.

Drawing Number HE514465 -ACM -HGN -	Highways England PIN	I Originator	I Volume	Rev
Z3 SW_PR_Z				P09
Location	I Type	I Role	I Number	

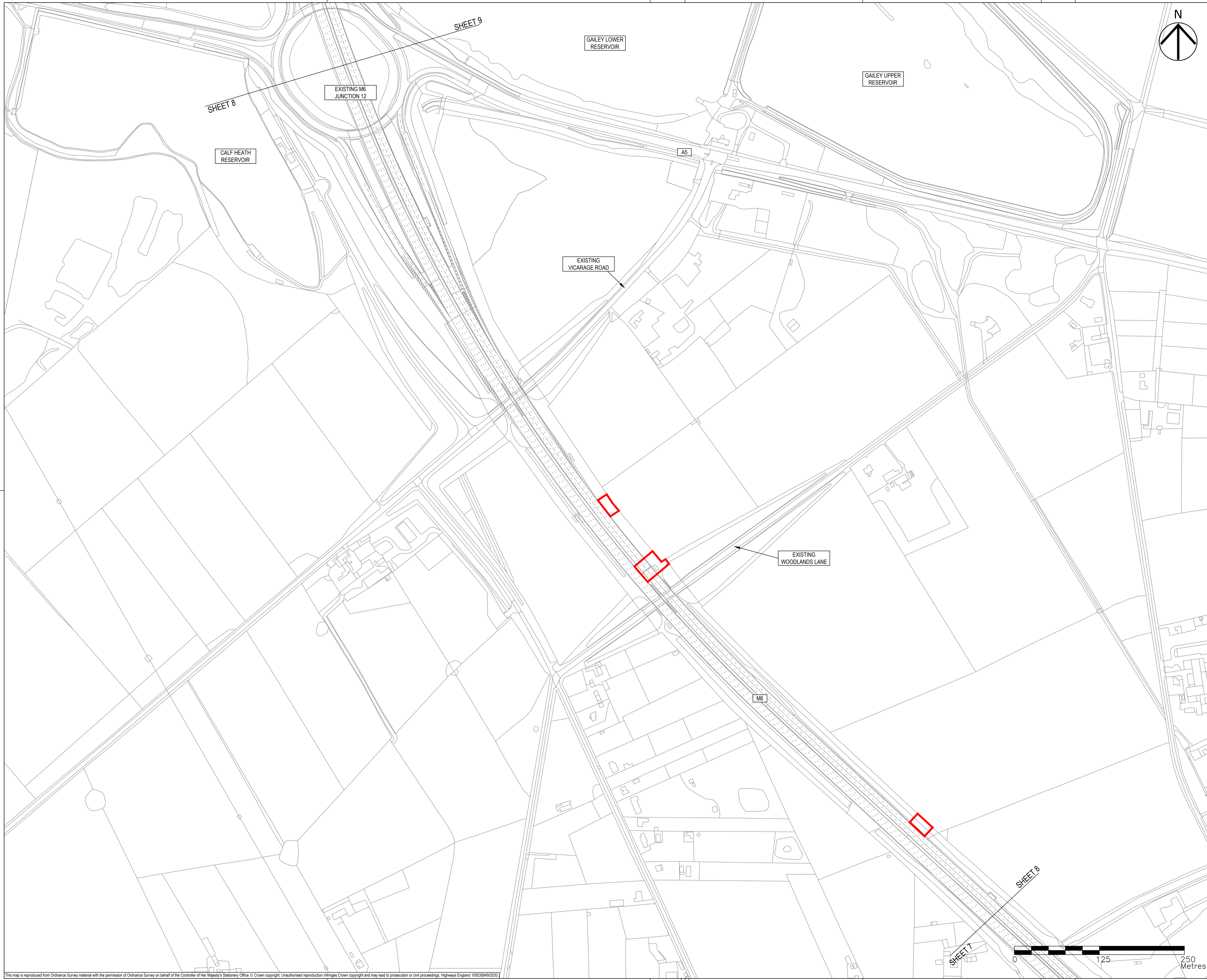

- NOTES
- THIS DRAWING IS TO BE READ IN CONJUNCTION WITH ALL OTHER RELEVANT DOCUMENTATION.
  - DO NOT SCALE FROM THIS DRAWING. USE ONLY PRINTED DIMENSIONS.
  - ALL DIMENSIONS IN MILLIMETRES. ALL CHAINAGES, LEVELS AND COORDINATES ARE IN METRES UNLESS DEFINED OTHERWISE.
  - THIS DRAWING IS TO BE READ IN CONJUNCTION WITH THE PROJECT HEALTH & SAFETY FILE FOR ANY IDENTIFIED POTENTIAL RISKS.

- KEY
- LIMITS OF LAND TO BE ACQUIRED OR USED PERMANENTLY OR TEMPORARILY (THE ORDER LIMITS)
  - LAND NOT INCLUDED WITHIN THE ORDER LIMITS
  - RETAINING WALLS
  - NON-MOTORISED USER ROUTE (PLEASE REFER TO STREETS, RIGHTS OF WAY AND ACCESS PLANS [TR010054/APP/2.7] FOR MORE INFORMATION)
  - EMBANKMENTS
  - CUTTINGS
  - VERGES / GRASSED AREAS

Revision Details	By	Date	Suffix
First Issue in Draft	MW	21/12/18	P01
	AM		
No significant changes noted from previous revision	JD	22/02/19	P02
	AM		
No significant changes noted from previous revision	MW	29/03/19	P03
	AM		
Road Markings and Hatching Added.	JP	14/05/19	P04
	AM		
No significant changes noted from previous revision	HS	15/08/19	P05
	DYT		
Refer to Design Change Tracker for details	JP	30/10/19	P06
	RR		
Background colour added	JP	17/12/19	P07
	DL		
Minor amendments.	MW	21/01/20	P08
	RR		
Hatching and key updated.	MW	08/10/20	P09
	RR		
	By	Date	Suffix
	Check		

Purpose of issue  
**DCO APPLICATION**

Client  
Highways England  
Floor 5  
Two Colmore Square  
38 Colmore Circus  
Birmingham  
B4 6BN

Development Consent Order Number  
**TR010054**

Project Title  
**M54 to M6 Link Road**

Development Consent Order Drawing Number  
**TR010054/APP/2.5**

Drawing Title  
**GENERAL ARRANGEMENT  
REGULATION 5(2)(O)  
SHEET 8 OF 10**

Designed	Drawn	Checked	Approved	Date
---	MW	AM	RR	08/10/20
Internal Project No. 60536736	Suitability S8			
Scale @ A1 1:2500H/1:2500V	Zone Highways General			

THIS DOCUMENT HAS BEEN PREPARED PURSUANT TO AND SUBJECT TO THE TERMS OF AECOM'S APPOINTMENT BY ITS CLIENT. AECOM ACCEPTS NO LIABILITY FOR ANY USE OF THIS DOCUMENT OTHER THAN BY ITS ORIGINAL CLIENT OR FOLLOWING AECOM'S EXPRESS AGREEMENT TO SUCH USE, AND ONLY FOR THE PURPOSES FOR WHICH IT WAS PREPARED AND PROVIDED.

Drawing Number	Highways England PIN	1 Originator	1 Volume	Rev
HE514465	-ACM	-HGN-		P09
Z3 SW_PR_Z		-DR-CH-1008		
Location	I Type	I Role	I Number	



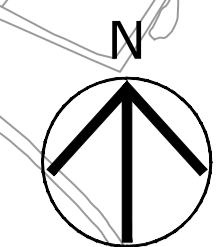

- NOTES**
- THIS DRAWING IS TO BE READ IN CONJUNCTION WITH ALL OTHER RELEVANT DOCUMENTATION.
  - DO NOT SCALE FROM THIS DRAWING, USE ONLY PRINTED DIMENSIONS.
  - ALL DIMENSIONS IN MILLIMETRES, ALL CHAINAGES, LEVELS AND COORDINATES ARE IN METRES UNLESS DEFINED OTHERWISE.
  - THIS DRAWING IS TO BE READ IN CONJUNCTION WITH THE PROJECT HEALTH & SAFETY FILE FOR ANY IDENTIFIED POTENTIAL RISKS.

- KEY**
- LIMITS OF LAND TO BE ACQUIRED OR USED PERMANENTLY OR TEMPORARILY (THE ORDER LIMITS)
  - LAND NOT INCLUDED WITHIN THE ORDER LIMITS
  - RETAINING WALLS
  - NON-MOTORISED USER ROUTE (PLEASE REFER TO STREETS, RIGHTS OF WAY AND ACCESS PLANS [TR010054/APP/2.7] FOR MORE INFORMATION)
  - EMBANKMENTS
  - CUTTINGS
  - VERGES / GRASSED AREAS

Revision Details	By	Date	Suffix
First Issue in Draft	MW	21/12/18	P01
No significant changes noted from previous revision	AM	22/02/19	P02
No significant changes noted from previous revision	JD	29/03/19	P03
No significant changes noted from previous revision	MW	14/05/19	P04
No significant changes noted from previous revision	JP	15/08/19	P05
Refer to Design Change Tracker for details	HS	30/10/19	P06
Background colour added	JP	17/12/19	P07
Minor amendments	JP	21/01/20	P08
Hatching and key updated	MW	08/10/20	P09

**DCO APPLICATION**

Client  
 Highways England  
 Floor 5  
 Two Colmore Square  
 38 Colmore Circus  
 Birmingham  
 B4 6BN

Development Consent Order Number  
**TR010054**

Project Title  
**M54 to M6 Link Road**

Development Consent Order Drawing Number  
**TR010054/APP/2.5**

Drawing Title  
**GENERAL ARRANGEMENT  
 REGULATION 5(2)(O)  
 SHEET 9 OF 10**

Designed	Drawn	Checked	Approved	Date
MW	MW	AM	RR	08/10/20
Internal Project No.	Suitability			
60536736	S8			
Scale @ A1	Zone			
1:2500H/1:2500V	Highways General			
THIS DOCUMENT HAS BEEN PREPARED PURSUANT TO AND SUBJECT TO THE TERMS OF AECOM'S APPOINTMENT BY ITS CLIENT. AECOM ACCEPTS NO LIABILITY FOR ANY USE OF THIS DOCUMENT OTHER THAN BY ITS ORIGINAL CLIENT OR FOLLOWING AECOM'S EXPRESS AGREEMENT TO SUCH USE, AND ONLY FOR THE PURPOSES FOR WHICH IT WAS PREPARED AND PROVIDED.				
Drawing Number	Highways England PIN	I Originator	I Volume	Rev
HE514465	-ACM	-HGN-		P09
Z3 SW_PR_Z		-DR-CH-1009		
Location	I Type	I Role	I Number	

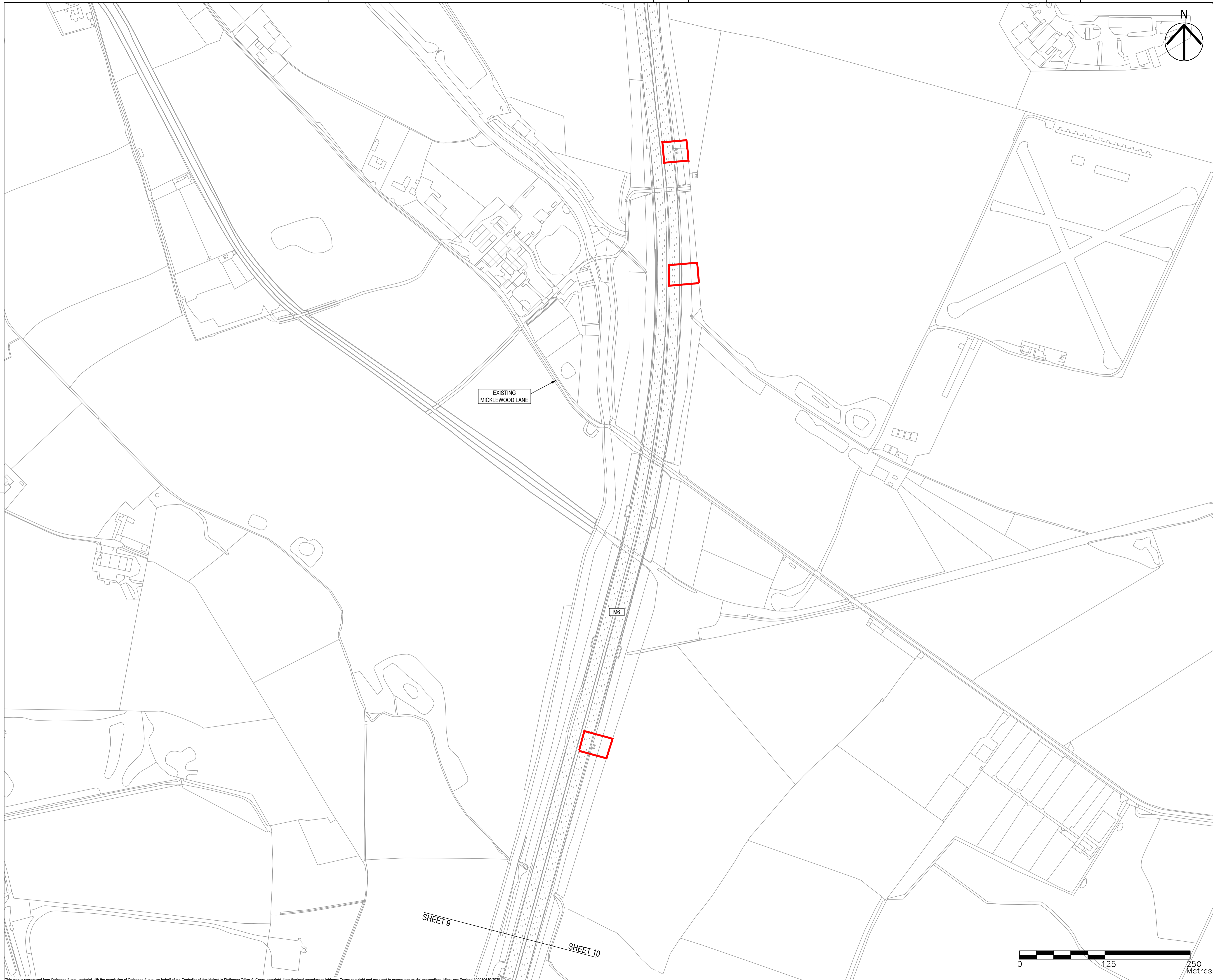

- NOTES**
- THIS DRAWING IS TO BE READ IN CONJUNCTION WITH ALL OTHER RELEVANT DOCUMENTATION.
  - DO NOT SCALE FROM THIS DRAWING. USE ONLY PRINTED DIMENSIONS.
  - ALL DIMENSIONS IN MILLIMETRES. ALL CHAINAGES, LEVELS AND COORDINATES ARE IN METRES UNLESS DEFINED OTHERWISE.
  - THIS DRAWING IS TO BE READ IN CONJUNCTION WITH THE PROJECT HEALTH & SAFETY FILE FOR ANY IDENTIFIED POTENTIAL RISKS.

- KEY**
- LIMITS OF LAND TO BE ACQUIRED OR USED PERMANENTLY OR TEMPORARILY (THE ORDER LIMITS)
  - LAND NOT INCLUDED WITHIN THE ORDER LIMITS
  - RETAINING WALLS
  - NON-MOTORISED USER ROUTE (PLEASE REFER TO STREETS, RIGHTS OF WAY AND ACCESS PLANS [TR010054/APP/2.7] FOR MORE INFORMATION)
  - EMBANKMENTS
  - CUTTINGS
  - VERGES / GRASSED AREAS

EXISTING MICKLEWOOD LANE

M6

SHEET 9

SHEET 10

Revision Details	By	Check	Date	Suffix
First Issue in Draft	MW	AM	21/12/18	P01
No significant changes noted from previous revision	JD	AM	22/02/19	P02
No significant changes noted from previous revision	MW	AM	29/03/19	P03
No significant changes noted from previous revision	JP	AM	14/05/19	P04
No significant changes noted from previous revision	HS	DYT	15/08/19	P05
Refer to Design Change Tracker for details	JP	RR	30/10/19	P06
Background colour added	JP	DL	17/12/19	P07
Minor amendments.	MW	RR	21/01/20	P08
Hatching and key updated.	MW	RR	08/10/20	P09

**DCO APPLICATION**

Client  
**Highways England**  
 Floor 5  
 Two Colmore Square  
 38 Colmore Circus  
 Birmingham  
 B4 6BN

Development Consent Order Number  
**TR010054**

Project Title  
**M54 to M6 Link Road**



Development Consent Order Drawing Number  
**TR010054/APP/2.5**

Drawing Title  
**GENERAL ARRANGEMENT  
 REGULATION 5(2)(O)  
 SHEET 10 OF 10**

Designed	Drawn	Checked	Approved	Date
MW	MW	AM	RR	08/10/20

Internal Project No. 60536736  
 Suitability S8  
 Scale @ A1 1:2500H/1:2500V  
 Zone Highways General

THIS DOCUMENT HAS BEEN PREPARED PURSUANT TO AND SUBJECT TO THE TERMS OF AECOM'S APPOINTMENT BY ITS CLIENT. AECOM ACCEPTS NO LIABILITY FOR ANY USE OF THIS DOCUMENT OTHER THAN BY ITS ORIGINAL CLIENT OR FOLLOWING AECOM'S EXPRESS AGREEMENT TO SUCH USE, AND ONLY FOR THE PURPOSES FOR WHICH IT WAS PREPARED AND PROVIDED.

Drawing Number	Highways England PIN	I Originator	I Volume	Rev
HE514465	-ACM	-HGN-		P09
Z3 SW_PR_Z		-DR-CH-1010		

Location I Type I Role I Number

